

# PG16



Note:

- 1、外壳材质 (Housing material) : Powder metallurgy
- 2、背隙, 无负荷时 (Backlash, at no-load) :  $\leq 1.0^\circ$
- 3、轴承型号 (Bearing at output) : Sleeve bearings
- 4、径向间隙 (Radial play of shaft) :  $\leq 0.05\text{mm}$
- 5、轴向间隙 (Thrust play shaft) :  $\leq 0.2\text{mm}$
- 6、齿轮箱适用于RF-030、RF-050和F-139马达。  
(The gear box can apply to RF-030 and RF-050 motors.)
- 7、警告: 齿轮箱齿轮极限扭矩 (损毁扭矩) 12kgf.cm。当使用低速、高速比时, 请选用低功率电机, 使用时请做好保护措施。  
(Attention: The breaking torque of the gear box is 12kgf.cm. When the motors using at low speed, high gear ratio, please choose low power motors, and do protection measurements.)

外形尺寸图/Appearance size

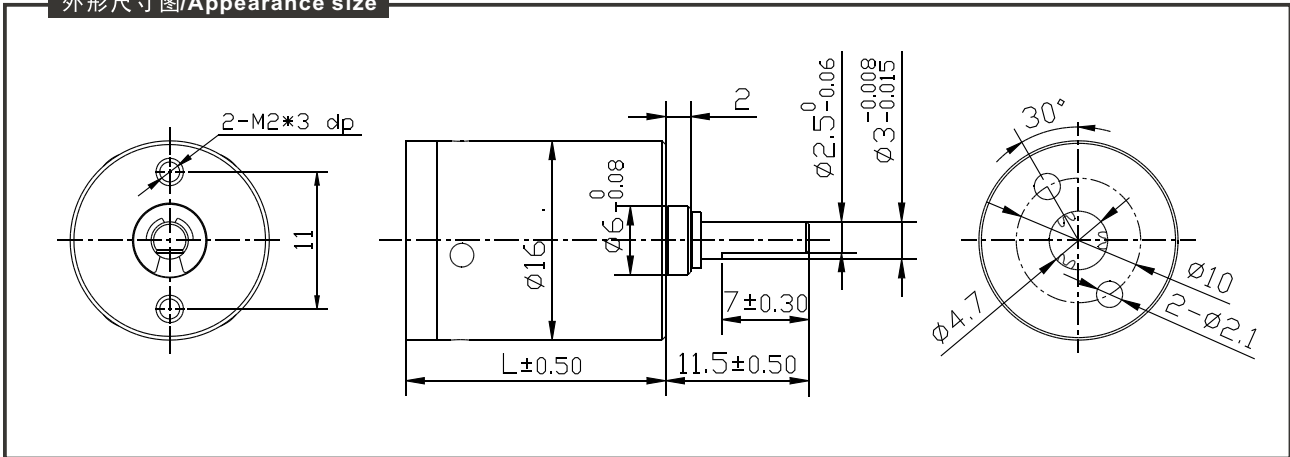

马达装卸方法/Motor Installation

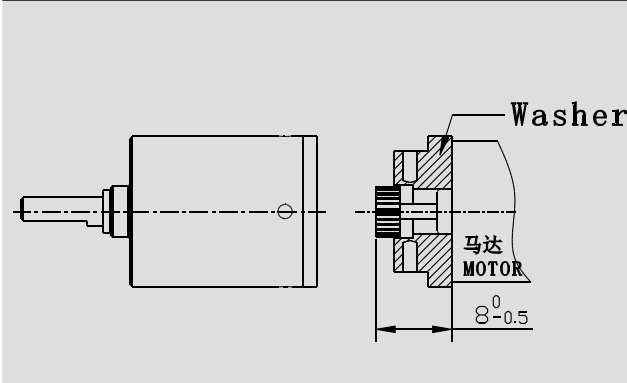

马达齿轮参数/Pinion Specifications

模数 Module	0.3	0.3	0.3
齿数 NO. of teeth	12	15	18
压力角 Pressure angle	20°		
孔径 Hole diameter	1.48		
减速比 Reduction ratio	4.75, 19, 22.5, 76, 90, 107, 304, 361, 428, 509, 712, 1216, 1444, 1715, 2036, 2418	4, 16, 64, 256, 1024,	12.3, 42.8, 150

使用温度范围/Operating temperature range:  $-10^\circ\text{C} \sim +60^\circ\text{C}$

使用相对湿度/Operating relative humidity: 20%~85%RH

标准减速比参数/Gearboxes Specifications

减速比 Reduction ratio	精确减速比 Reduction absolute	额定允许扭力 Rated tolerance torque	极限扭矩 Max breaking torque	效率 Efficiency	级数 Number of stages	齿轮箱长度 Gearbox length "L" mm
4, 4.75	4, 4 <sub>3/4</sub>	1.0kgf·cm	3.0kgf·cm	90%	1	13.7
12.3, 16, 19, 22.5	12 <sub>1/4</sub> , 16, 19, 22 <sub>9/16</sub>	1.5kgf·cm	4.5kgf·cm	81%	2	17.3
42.8, 64, 76, 90, 107	42 <sub>7/8</sub> , 64, 76, 90 <sub>1/4</sub> , 107 <sub>11/64</sub>	4.0kgf·cm	12.0kgf·cm	73%	3	20.9
150, 256, 304, 361, 428, 509	150 <sub>1/16</sub> , 256, 304, 361, 428 <sub>11/16</sub> , 509 <sub>17/256</sub>	4.0kgf·cm	12.0kgf·cm	65%	4	24.5
712, 1024, 1216, 1444, 1715, 2036, 2418	712 <sub>51/64</sub> , 1024, 1216, 1444, 1714 <sub>3/4</sub> , 2036 <sub>17/64</sub> , 2418 <sub>67/1024</sub>	4.0kgf·cm	12.0kgf·cm	59%	5	28.1